

CANTERBURY CAMPUS SELF-GUIDED TOUR

A guide for visitors





WELCOME

Welcome to the University of Kent and our Canterbury campus. Built on 300 acres of parkland, it really is an inspirational place to study, with spectacular views over the city of Canterbury.

About the University

The University stands proudly on land that was originally a gift to Augustine, the first Archbishop of Canterbury, from King Æthelberht of Kent.

Established in 1965 with one site and 500 students, the University has grown significantly – we now have over 20,000 students and have campuses and centres in both the UK and Europe.

The UK's European university

- There are 20,125 total students, with 158 nationalities represented
- Multiple locations across Kent, and a strong European presence
 - The University of Kent, Canterbury
 - The University of Kent, Medway
 - The University of Kent, Tonbridge – a centre for part-time study, offering short courses, which can be studied for self-development, to prepare for a degree or for personal interest
 - The University of Kent, Brussels – our Brussels Centre specialises in international studies
 - The University of Kent Paris School of Arts and Culture – innovative cross-disciplinary postgraduate programmes in the Humanities
 - The University of Kent, Athens – our unique Master's programme in Heritage Management combines the worlds of business and archaeology
 - The University of Kent, Rome – the study of the ancient world and art history is offered at our newest European centre.

Kent's collegiate structure

Kent is a collegiate university: a university composed of different colleges. All students become a member of a college on registration and retain their affiliation throughout their study.

The University has six colleges, named after distinguished British figures who have made an outstanding contribution to areas of academic study:

- **Eliot** – The poet, T.S. Eliot
- **Rutherford** – The physicist, Lord Rutherford
- **Keynes** – The economist, Lord Keynes
- **Darwin** – The biologist, Charles Darwin
- **Woolf** – The writer, Virginia Woolf
- **Turing** – The computer pioneer and WWII code breaker, Alan Turing

College life

The colleges provide a ready-made, friendly community, easing the transition from home to university life. Each college has a student committee who host some fantastic events and contribute to the way the colleges are run. Each college has a Master who can offer advice, help and support. They are a first port of call when students need assistance, with all matters dealt with in the strictest confidence.

Accommodation overview

- Over 5,400 bedrooms, most of which have been recently refurbished or are newly built
- A wide range of accommodation to suit all budgets – over 1,050 bedrooms are priced at under £4,500 per year
- Over 85% of bedrooms have self-catering facilities and nearly 60% are en-suite
- Accommodation costs include gas, electricity and water charges, as well as wired and Wi-Fi internet access and personal room contents insurance
- High-speed internet connection in all study bedrooms
- Students can also connect smartphones, tablets and other devices from their study bedrooms, as well as using the existing wired network points
- We have a range of catering packages designed to save money (www.kent.ac.uk/catering/other-services/catering-packages.html)

Accommodation types

Type	Where?	What's included?	Facilities
Part-catered (Bed and Flex) Available for 37 weeks (includes part of the winter vacation and all of the spring vacation)	Rutherford College Eliot College	An allowance of £8.00 per day to spend on food in a choice of eight venues across campus, seven days a week during term-time	Rooms are arranged in corridors with shared bathrooms and a small kitchenette (suitable for preparing hot drinks and snacks only)
Part-catered (Bed and Bistro) Available for 31 weeks (excluding winter and spring vacations)	Keynes College (main building) Becket Court	Breakfast and dinner in Dolche Vita bistro in Keynes College (Mon-Fri) Brunch and dinner available in Rutherford College at weekends	All rooms are en-suite
Self-catered Available for 39 weeks (including winter and spring vacations)	Park Wood (flats and houses) Keynes College (flats and houses) Tyler Court B/C (flats) Darwin College Turing College	Shared kitchens, fully equipped with oven and hob, fridge/freezer and microwave	All en-suite except Park Wood houses, Darwin College and Keynes houses
Postgraduate* Available for a fixed 51-week contract	Woolf College	Shared kitchens, fully equipped with oven and hob, fridge/freezer and microwave	All rooms are en-suite

*See www.kent.ac.uk/accommodation/canterbury/apply/guide/pg-accomm.html for other postgraduate accommodation

Applying for accommodation

Undergraduate students

- New full-time students who select Kent as their first choice and who apply before 31 July will be offered University accommodation
- Students holding Kent as their insurance choice should apply by 31 July and will be offered accommodation subject to availability
- New students who do not meet the 31 July deadline may be offered accommodation on a first come, first served basis, subject to any remaining availability
- Accommodation for Clearing and Adjustment applicants will be offered in early September subject to remaining availability.

Postgraduate students:

- must formally accept an offer to study at the University and fully meet all the conditions of the offer before 31 July
- must apply online and make an advance payment (non-refundable) before 31 July.

Current prices and other information is available on our website: www.kent.ac.uk/accommodation
 We regret it is not possible to view inside the accommodation during your tour.



ABOUT THIS TOUR

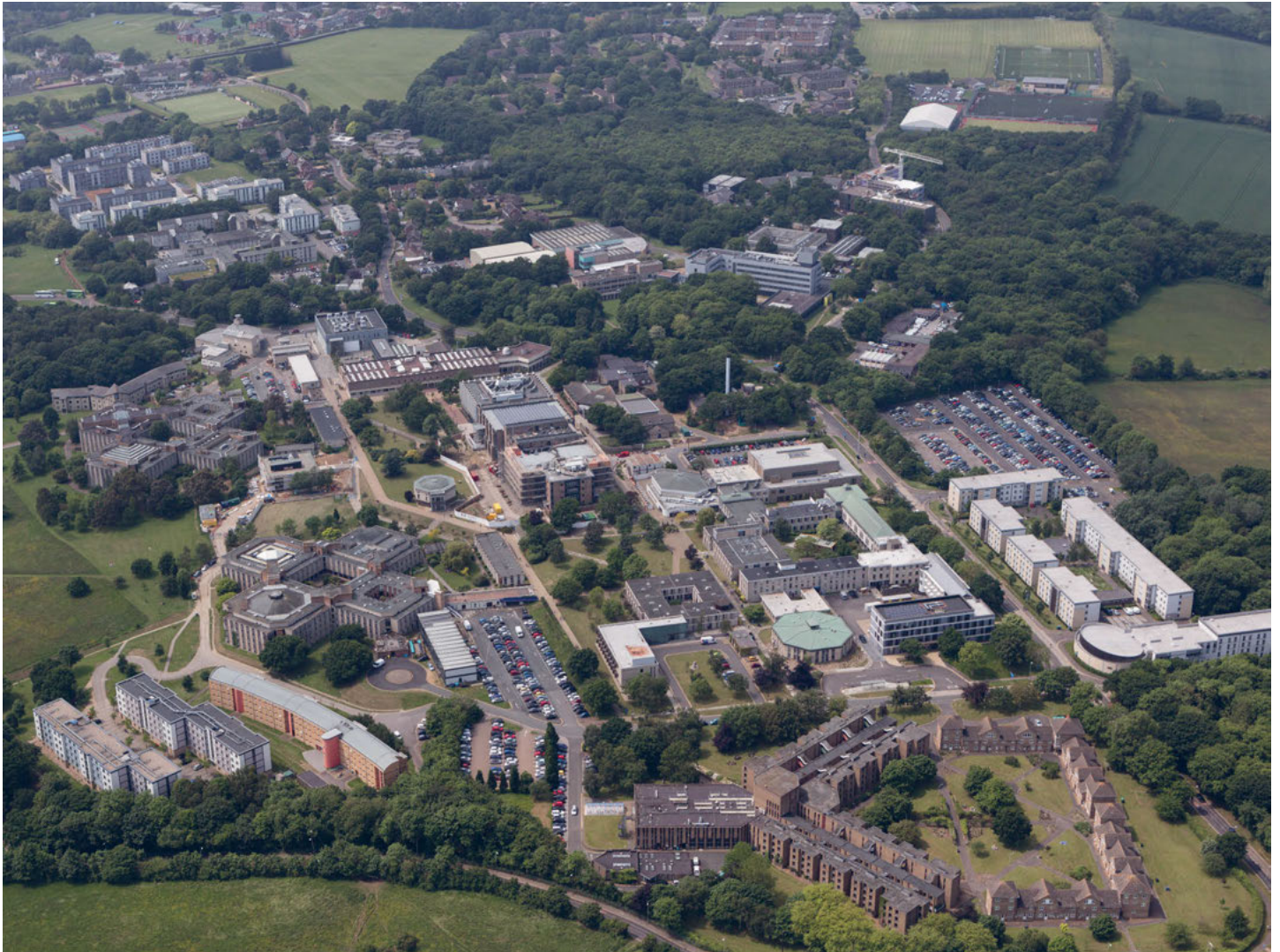

The following tour will take approximately 45 minutes. To visit Park Wood student village, add an extra 30 minutes.

On arrival

If you are arriving by car please park in the Visitors' Car Park, then make your way to the Visitors' Reception in the Registry Building [K1], which is the start of the tour. There are toilet facilities available in the Registry Building.

The instructions in *blue Italics* give walking instructions and the words in **bold** point out areas of interest. Grid locations are given in brackets [] – please refer to the campus map on p14.

The campus

The Canterbury campus is built on 300 acres of parkland and is a large site. We recommend comfortable footwear and, in case of bad weather, waterproof clothing.

- All facilities on one site: academic buildings, student accommodation, library, sports centre, arts and music, students union (including a nightclub and student media centre) campus shops, restaurants, bars and cafés, nursery, security services, student support and wellbeing services
- Only 20 minutes' walk into the city of Canterbury
- The campus is on a direct bus route into the city centre; buses arrive and depart approximately every eight minutes.

If you have travelled to the University by car, you may prefer to drive to Park Wood student village at the end of your tour.

Directions to Park Wood student village by car

Exit the Visitors' Car Park. At the junction with Giles Lane, turn left and you will come to a mini-roundabout.

Take the second exit at the mini-roundabout onto Park Wood Road. Continue along Park Wood Road until you come to the entrance to the Sports Pavilion, which will be on your right.

Take the next turning on your left and follow the road through Park Wood; you will pass Nickle [F2], Kemsdale [F4] and Purchas [F5] Courts. Continue round the circular route back to the main junction on Park Wood Road and then turn right and return to the main campus to exit the University.



TOUR ROUTE

The tour starts at the Visitors' Reception in the Registry Building [K1].

Exit through the sliding doors of the Visitors' Reception. Turn to your right, following the footpath to the road. You will pass a large sculpture on your left, entitled 'The Split of Reason', by Patrick Crouch, an assistant lecturer in the Kent School of Architecture.

In front of you is **Darwin College [E5]**. Darwin was the fourth college established at Kent, opening in 1970. It is named after the famous naturalist, Charles Darwin.

- **Self-catered accommodation** in flats of five bedrooms, with two flats sharing a kitchen.
- There is a mixture of standard and large bedrooms available with shared toilet and shower facilities.

Darwin also has its own bar, **Origins Bar and Grill**. It's famous for its smoky pitmaster classics and gourmet burgers, and there's also a great range of vegetarian and vegan options. Origins is one of the most popular bars on campus, with many events taking place during term-time. These include Ruby Tuesdays, an alternative/indie night, and the Origins pub quiz, held every Sunday evening.

Turn right and follow the footpath to the phone box.

Up ahead in front of you is **Tyler Court [K5]**.

- **Self-catered, en-suite accommodation**
- **Tyler Court A (postgraduate)**: single en-suite bedrooms in corridors with fully equipped kitchens, shared between eight postgraduate students.
- **Tyler Court B and C (undergraduate)**: single en-suite bedrooms arranged in eight or nine bedroom flats, with fully equipped kitchens (pictured on p4).
- Tyler Court has adapted ground floor rooms with good access for students with mobility issues, and wheelchair users.

Follow the footpath immediately to the right and continue ahead. The building on your left is **Rutherford College [K4]**. Rutherford was the second college to be built on campus, opening in 1966. It is named after Lord Ernest Rutherford who developed the nuclear theory of the atom. Rutherford houses the schools of History, and Politics and International Relations.

- **Part-catered accommodation (Bed and Flex)**
The cost of accommodation includes a food allowance of £8.00 per day that can be used in a choice of nine different catering venues around campus, seven days per week, during term-time.
- Seven students share a corridor where there are a mixture of standard and large rooms. There are two showers, a toilet and a small kitchenette, suitable for the preparation of drinks or snacks only. The kitchenette includes a fridge, kettle and microwave. Each bedroom has its own sink.

- Rutherford has adapted ground floor rooms with good access for students with mobility issues, and wheelchair users.

Rutherford Dining Hall is located in the centre of the college. It offers a traditional cafeteria-style experience, including a wide range of breakfast, lunch and evening meals, along with a wok bar and a salad bar, with a new menu every day. Vegetarian, healthy options and halal food are also available. Everyone is welcome – students don't need to be affiliated with the college in any way.

Bag-it in Rutherford Dining Hall has touchscreen self-service ordering and offers a variety of snacks including jacket potatoes, soup and fresh sandwiches and baguettes. *Continue past Rutherford College.* Just past the College is **Rutherford College Extension [K3]**, which is home to the School of English. *Continue along the footpath, bearing round to the left.*

Continue forward and you will come to an octagonal building. This is the **Senate Building [J12]**, which was built in the 1960s and was originally used as committee rooms for the University Council. As you walk past the Senate Building, take a moment to admire the spectacular views to your left of the city and **Canterbury Cathedral**, where Canterbury students graduate.

The very large building to your right, in the centre of campus, is the **Templeman Library [J11]**. You will have the opportunity to go into the Library later on the tour.

The building you can see to your left is the new **Wigoder Law Building [J17]**, which has facilities for the **Kent Law Clinic** and a mooted chamber.

The **Kent Law Clinic** is a partnership between students, academics and solicitors and barristers who practise locally. It provides a public service for local people who need legal advice and representation, but cannot afford to pay for it, and enhances the education of students in the Kent Law School through direct experience of legal practice.

Continue to follow the footpath. Next on your left is **Eliot College Extension**, and the main reception for **Kent Law School [J15]**.

Further ahead is Eliot College [P5]. Eliot College was the University's first college, opening in 1965. It is named after the poet, T.S. Eliot.

- **Part-catered accommodation (Bed and Flex)**
The cost of accommodation includes a food allowance of £8.00 per day that can be used in a choice of nine different catering venues around campus, seven days per week, during term-time.
- Seven students share a corridor where there are a mixture of standard and large rooms. There are two showers, a toilet and a small kitchenette, suitable for the preparation of drinks or snacks only. The kitchenette includes a fridge, kettle and microwave. Each bedroom has its own sink.

Eliot is home to **Mungo's Bar and Bistro** (pictured below). Mungo's offers burgers, speciality salads and grilled sandwiches, fruit smoothies, sundaes or speciality milkshakes. There's also free Wi-Fi, laptop stations and a games room.

Mungo's also has some great events – there are regular DJs throughout the year, a pub quiz every Monday, sports team nights on Wednesdays and Massive Mungo's, one of the best nights on campus.



TOUR ROUTE (CONT)

Continue past Eliot College along the footpath, and look across to the left. The building you can see on the other side of the car park, behind Eliot College, is Becket Court [P4].

Becket Court is another of our student residences. It is named after Thomas Becket, the Archbishop of Canterbury murdered in Canterbury Cathedral in 1170.

- **Part-catered (Bed and Bistro) en-suite accommodation**
- Seven students share a kitchenette, which is equipped with a fridge, kettle and microwave, and is suitable for preparing drinks and snacks only.
- Students have breakfast and dinner in Dolche Vita (in Keynes College) Monday to Friday, with brunch available in Rutherford College at weekends and bank holidays.

Continue forward and you will arrive in The Plaza, described as the 'heart of campus' by our students. In The Plaza you'll find:

- **Blackwell's/Caffè Nero** – Blackwell's stocks most of the books found on course reading lists and allows students to buy and sell second-hand books. Caffè Nero is open from 8.30am – 6pm Monday to Friday and 10.00am – 4.00pm on Saturdays
- **NatWest** cash machine
- **Jobshop** – a service which helps students find part-time, temporary or one-off jobs to suit timetables and skills
- **Essentials** – students' union shop that stocks fresh and frozen produce, convenience items, wines, spirits and beers, and basic household supplies

- **Bake n Bite** (in Essentials) sells hot pastries/pies and has a salad bar. From 12 midnight to 6am it is open via a hatch service
- **Street Kitchen** – delicious urban street food
- **Locke Building** (past Essentials, around the corner, directly on your left) houses the **Student Activities Centre** for volunteering, societies, course reps and RaG (Raise and Give). There is also a post-box outside the Locke building.

The **striking rippling façade** you can see to your right, and pictured below, is part of Kent School of Architecture's Digital Crit Space, one of the most advanced learning environments in the UK. The façade responds instantaneously to local wind conditions to create a stunning visual effect.

Continue through The Plaza. The grey building ahead of you is the **Jarman Building [J16]**, which houses the School of Arts. Named after the film director Derek Jarman, it has drama, art and film studios, teaching rooms, a postgraduate centre and academic and administrative offices.

Continue ahead and you will come to **The Venue [P2]**, which is the large building directly opposite you.

- State-of-the-art, award-winning nightclub with a capacity of 1,200, open three nights a week
- Range of music genres – our premier 'Vensday' night on Wednesdays caters for all sports clubs and societies. Friday nights turn a bit electro with a hint of dubstep and drum and bass, while Saturdays are reserved for our themed commercial nights.

- Student Media Centre for Kent's radio station (CSR.fm), student newspaper (*inQUIRE*) and TV station (KTV).
- There is a cash machine outside the building.

When you reach the road, look down to your left and you will see the **Mandela Building [P4]**, the home of **Kent Union**, the students' union at the University of Kent which:

- offers over 200 societies and 66 sports clubs, from the traditional such as football and rugby to the unusual such as ski and snowboarding, caving and Quidditch!
- employs officers that are elected by the student body, specifically for the academic, welfare and social needs of Kent students
- co-ordinates KSCV (Kent Student Certificate for Volunteering) and RaG (Raise and Give)
- provides a **Student Advice Centre** for help with finances, housing, immigration and academic issues.

Cross over the road, walk past The Venue and follow the footpath round to the left. Up in front of you to the right (just out of sight) is the **bus turning circle** where you can catch a bus into the city centre and to Whitstable and Herne Bay. There are also various bus stops located around the campus.

- Frequent and reliable bus service from the campus to the city centre – look out for the **bright green Unibus** while you are on the tour.
- The Unibuses have free Wi-Fi and run on 100% biofuel, a sustainable fuel source.
- £2.90 for a day ticket, or £10.00 for a weekly ticket between the University and Canterbury city centre on presentation of the KentOne student ID card.



Before you get to the blue 'To Canterbury' sign, cross the road and continue along the footpath until you come to a right turn. Cross over the road and follow the footpath to the right. You will see the Careers and Employability Service [P6] in front of you and Keynes College [N6] up ahead. Continue forward and you will come to a car park and the glass-fronted main entrance to the college.

Keynes College was the third college to be established at Kent, opening in 1968. It is named after the economist Lord Keynes. It offers two types of accommodation:

- **Self-catered en-suite accommodation in flats and houses**
 - **Flats:** seven students share a spacious kitchen. The bedrooms are all en-suite and students can apply for standard or extra-large rooms.
 - **Houses:** nine students share a spacious and modern kitchen. Students share a shower and toilet with one other person.
- **Part-catered (Bed and Bistro) en-suite accommodation in the main building.**
 - Students share a kitchenette, which is equipped with a fridge, kettle and microwave, and is suitable for preparing drinks and snacks.
 - Students have breakfast and dinner in Dolche Vita Monday to Friday, with brunch available in Rutherford College at weekends and bank holidays.

Keynes bistro, Dolche Vita, has an extensive menu offering a range of flavours and fusion dishes from across the world. Keynes also has its own bar, K-Bar (pictured on this page), which has a relaxed and comfortable atmosphere where you can get a made-to-order juice, watch live sports, listen to live bands, or simply catch up with friends.

At the main entrance to Keynes College, continue forward through the car park, following the path to your left. The buildings you can see in front of you are part of Keynes accommodation.

Continue forward, bear left through the small turning/loading area and continue forward. Bear right around the circular wooden structure in front of you (Keynes reception) and continue forward. You will see Keynes Block R in front of you. Walk towards Block R and turn left. You are heading towards Turing College [N7]. Enter Turing College from the next turning on your right.

Turing is our newest college, established in 2014 and named after the famous WWII code breaker Alan Turing.

- **Self-catered accommodation in flats and houses**
 - **Flats:** nine students share a spacious kitchen. The bedrooms are all en-suite and students can apply for large or extra-large rooms. Adapted rooms for students with disabilities are available.
 - **Houses:** nine or 12 bedrooms with large spacious kitchens on the ground floor. There are four bedrooms on each floor, with two sets of shower and toilet facilities provided.



Turing College also has Hut 8, which is the place to go for takeaway-style food. It's open from midday until 11pm, Tuesday – Sunday and the menu includes dishes cooked on the grill, rustic homemade pizza, and their famous fried chicken. As well as great food, Hut 8 also has computers, gaming facilities, and you can play pool or table tennis.

To visit Hut 8: Continue forward and take the first turning on your left.

To return to the tour: Retrace your steps back to the entrance to Turing College. With the entrance behind you, turn left and continue forward until you reach the main road.

Look to your left and you will see a sign for the University Medical Centre and Cheadles Chemist.

- The University Medical Centre is an NHS general practice, made up of six general practitioners, including nurse practitioners, practice nurses and health care assistants.
- Cheadles is open 9am – 6pm (Monday to Friday).
- All students who live on campus are advised to register with the Medical Centre.

Turn right and continue forward. You will come to a building with a blue domed roof. This is the Canterbury Mosque, used for daily prayers and services by the local community and students at the University.

Immediately after the mosque, take the footpath to the left and continue ahead. The building you can see ahead is the back of the Sports Centre. *Continue forward to the end of the footpath.*

The next part of the tour takes you to Park Wood, our student village. If you would prefer to drive to Park Wood at the end of the tour, please refer to the directions on p5.

 Continue with the tour from this point on p10 if you do not want to walk to Park Wood.

At the end of the footpath, look to your left. You will see a cycle lane and another footpath. The main entrance to the Sports Centre is to your right.

To visit Park Wood: Follow the footpath to your left, through the woodland, until you come to a wooden bench. You will see a footpath leading off to the left. Follow this footpath to enter Park Wood, which offers self-catered accommodation in flats and houses:

- **Self-catered accommodation in flats**
 - Single, en-suite study bedrooms arranged in four, five or six-bedroom flats
 - Kitchen/diner with oven, hob, fridge freezer and microwave
 - All rooms have computer links and TV aerial points.
- **Self-catered accommodation in houses**
 - Terraced houses with five or six single bedrooms
 - All houses have computer links
 - Residents share kitchen and bathroom facilities.
- Park Wood has adapted ground floor rooms in Kemsdale Court with good access for students with mobility issues, and wheelchair users.

TOUR ROUTE (CONT)

Continue along the footpath. You will come to the road, and a phone box will be across to your left. Cross the road and bear right. Continue forward, following the 'way out' signs. Bishopden Court is on your left and Farthings Court is on your right. Walk past the large blue 'Park Wood' sign and turn left. You will pass Park Wood Study Hub, equipped with PCs, laptop work desks and a social area.

Follow the footpath in front of you. The building to the right of the footpath is Park Wood Essentials, a convenience store that sells everything from fresh fruit and vegetables to stationery. You will pass a launderette on your right. At the end of the footpath, turn right to come to the front of the store and continue forward. Park Wood reception is next door to Park Wood Essentials. The construction work you can see is the beginning of our new student hub building, due for completion in 2018.

Go down the slope to your left, turn right and continue forward to the main road. Turn left. At the end of the main road, you will see a large covered structure. This is our tennis and netball centre, which has three indoor courts.

Look further to your left and you will see the Sports Pavilion, where we have a range of sports facilities:

- three outdoor tennis and netball courts
- one recreational basketball court
- three grass football pitches
- two rugby pitches
- cricket square
- one synthetic multi-purpose hockey/football pitch
- one 3GX football pitch
- tiered spectator seating
- two sports pavilions with teaching rooms, changing facilities, showers and viewing balconies.

Turn right and join the footpath, continuing forward. Up ahead in front you will see the Sibson Building, one of our newest academic buildings (pictured below). Sibson is the new home for Kent Business School and the School of Mathematics, Statistics and Actuarial Science, and is named after Robin Sibson, Kent's third vice-chancellor.

Continue forward. Cross the road and continue forward, past the Sibson Building. Walk past the 'Main University Campus' blue sign, cross the road and continue forward. You will come to a blue sign for the Sports Centre car park. Turn right here and continue forward.

The grey building to your left is the Ingram Building, which has recently been refurbished and is home to the School of Physical Sciences. The orange building up ahead in front is the University Sports Centre [H5]. Facilities include fitness programmes, exercise assessments, sports courses and workshops, nutrition consultations, leagues, competitions and nearly 40 aerobic and dance classes every week. It also facilitates 50 student sports clubs run by Kent Union.

Indoor facilities in the Sports Centre:

- fully equipped fitness suite and physiotherapy clinic
- air-conditioned dance studio with sprung wooden flooring (pictured on p11)
- three multi-purpose sports halls for activities including netball, basketball, table tennis, badminton, volleyball, fencing, 5-a-side football, cricket and inline hockey.

 If you are not walking to Park Wood student village, you can continue with the tour from here.

At the main entrance to the Sports Centre (with the Sports Centre on your right) continue forward to the covered arch in front of you.

This is the Stacey Building [H7], home to the School of Biosciences. Pass under the arch and follow the footpath to the main road. The sculpture you can see ahead is called 'Huella Humana' (human fingerprint). It is a female nude encased in a steel DNA helix, created in collaboration with a local artist, Asun Bassas Mujtaba, and represents the advances in genetics at the end of the 20th century.

Cross the road at the pedestrian crossing. Once you have crossed the road, you will see two paths immediately in front of you. Take the path on the left. You will see Santander bank [J8], which has a cash machine.

Campus Security [J4] is situated next to Santander. Campus Security staff are on duty 24 hours a day, 365 days a year. They maintain a safe environment for everyone on campus, and provide practical safety advice and support.

- Students are provided with either a key and/or an electronic fob for bedroom and building access.
- Each student residence has a staffed reception until 8pm. A member of Campus Security is present in the building from 8pm.
- Security staff will accompany students, on foot, anywhere on campus, at any time, via our walking taxi service.

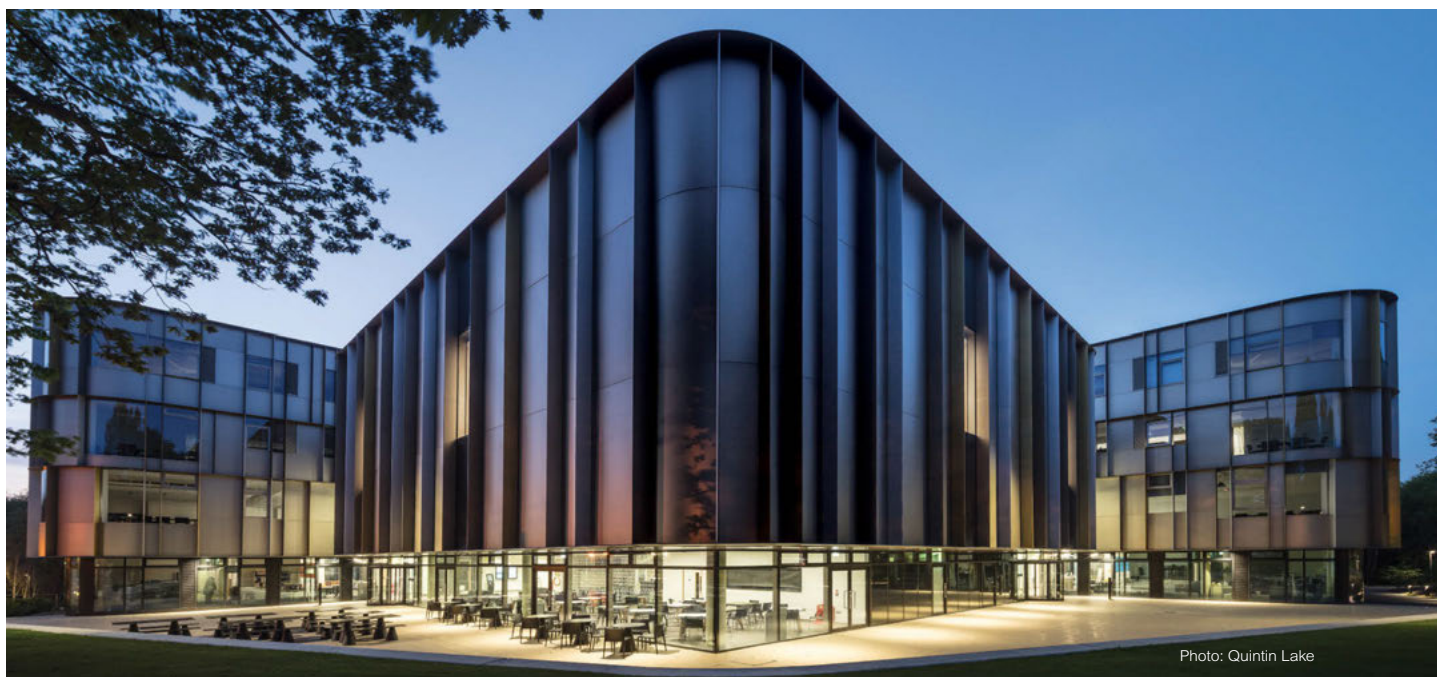

Photo: Quintin Lake

Situated between Campus Security and Santander bank is the **Student Learning Advisory Service [J7]**. This is a free, friendly service providing confidential guidance and information on all aspects of effective learning and study skills. Leaflets, advice and workshops are available on a wide range of topics such as:

- essay skills
- revision and exam strategies
- seminar papers and presentation skills
- time management.

Bear right and continue forward with the bank and Campus Security behind you. Go down the steps in front of you or use the ramp to the right of the steps. Continue ahead.

The long building to your right is the **Marlowe Building**, home to Kent School of Architecture, the School of Anthropology and Conservation and **Create Café**. The large metal sculpture you can see is *Tensegrity*, unveiled in 2015 to celebrate the 50th anniversary of the University and the tenth anniversary of the founding of the Kent School of Architecture.

Templeman Library

On your left is the spectacular **Templeman Library [J11]**, named after our first vice-chancellor, Geoffrey Templeman. At 18,750m², it is the largest library in the county of Kent.

Library opening hours

The Library is open 24/7 during term-time and long hours at other times. All students and staff are required to scan their KentOne ID card to enter and exit the library.

All visitors are welcome and should report to the Welcome Desk in the main entrance. Visit www.kent.ac.uk/library/opening for daily opening times.

To enter the library: there is a slope opposite the entrance to Create Café. *Walk up the slope and enter the Library through the Main Entrance.*

The library sits at the heart of the campus and offers stunning views of the city of Canterbury. It has recently been extended and refurbished to create a modern intellectual centre for our research-led community, and now houses over 1,300 study spaces, 500 PCs and laptops to use, bookable study rooms, 260-seat lecture theatre and seminar rooms.

The library houses rich collections of over one million books, e-resources and databases to support study and research. Specialist library and IT support is also available for your subject. Our unique Special Collections and Archives, including the British Stand-Up Comedy Archive and British Cartoon Archive, are held here.



You can also visit the impressive **Reading Room and Gallery** that hosts a variety of exhibitions. Students can enjoy a break from their studies in the spacious library café. It serves freshly baked pastries, sandwiches, snacks and hot and cold drinks.

Kent students have access to all three University libraries: the Templeman Library at Canterbury, the Drill Hall Library on the Medway campus and the library at the Tonbridge Centre.

Continue along the footpath. Continue ahead. At the steps to the entrance for Eliot College, turn left and continue forward, passing the Eliot Extension (Kent Law School) and the Wigoder Law Building on your right. Walk past the Senate Building. Continue forward and go up the steps in front of you. There is a ramp to the right of the steps.

Look down and you will see the beginning of the commemorative **Crab and Winkle path**, one of the University's 50th anniversary legacy projects.

The Footsteps Project

Hundreds of thousands of individuals have been involved with the University since its inception in 1965 and the path is a celebration of those who make the University what it is – our staff and students. The path follows the 19th-century Canterbury and Whitstable Railway, known locally as the Crab and Winkle line, which runs under this part of the campus.

Continue down the path. You will see personalised bricks, inscribed by staff, past and present, current students and alumni. At the end of the path you will come to the **Gulbenkian [J10]**:

- professional touring theatre
- performances range from stand-up comedy to Shakespeare and classical concerts to contemporary dance
- students have an opportunity to use the theatre
- the building houses the **Gulbenkian Café** and on-campus cinema, **Gulbenkian Cinema [J2]** showing everything from recent releases to independent sector and foreign language films
- In July 2017, Gulbenkian was awarded National Portfolio Organisation (NPO) status by Arts Council England. The award includes funding to support projects run by, with, and for children and young people, including the award-winning bOing! International Family Festival and ART31 – Gulbenkian's Kent-wide project to connect young people with opportunities in the arts.

You will see a sculpture outside the Gulbenkian. Entitled '**Father Courage**', it was funded by the Gulbenkian Foundation and created by Frederick Edward McWilliam. Its title refers to Bertolt Brecht's play, *Mother Courage*. Originally installed near the **Gulbenkian Theatre** in 1969, it was moved to its current position in 1974 following the partial collapse of the **Cornwallis Building**, due to the subsidence of the Crab and Winkle railway tunnel. The tunnel has since been filled in!



TOUR ROUTE (CONT)

The buildings to your right form **Cornwallis South [J3]**, which houses the **Computing Laboratory [J3]** and **IT Services [J3]**, which provides technical help for computer users on campus.

The University has:

- around 1,000 open access student PCs on campus, giving Kent one of the highest computer to student ratios in the country
- free wireless access to the internet and Kent network from hotspots across campus and a wired and wireless connection from each study bedroom
- an online Student Guide and Virtual Learning Environment (VLE)
- remote access to files and resources on the Kent network – work from home and on the move
- comprehensive helpdesk support.

Continue forward, past the Gulbenkian Café and pass under the arch. The building to your left is the **Colyer-Fergusson Building [D7]**, which opened in 2012 thanks to a generous donation from Sir James Colyer-Fergusson, the Colyer-Fergusson Charitable Trust, the Higher Education Funding Council for England and many other donors. You can see their names on the board in the foyer. With its state-of-the-art facilities, flexible acoustics and retractable seating, it is the venue for all our rehearsals and student music-making, many of the University's major concerts and for visiting musicians, both local and international.

Continue down to the main road. Across the road and to the right is **Woolf College [D6]**, our postgraduate college. Opened in 2008 and named after the novelist Virginia Woolf, it was the fifth college to be established on campus.

- **Self-catered accommodation for postgraduate students** registered for a full academic year (51 weeks).
- Between five and eight students live in flats, which have a large shared kitchen and dining area (pictured above).
- Studio flats, standard en-suite and large en-suite rooms are available.
- Woolf has adapted ground floor rooms with good access for students with mobility issues, and wheelchair users.

Turn right at the end of the footpath and follow it round to the right. You will come to a pedestrian crossing. *Cross the road* and you will see some steps and a ramp to your left. *Use either of these to access Woolf College [D6]. Follow the footpath through the College.*

The building in the centre on your left is the **College Reception**. *Continue forward until you pass the large wooden structure on your left.* The large building in front of you is the **Academic Block**, which houses seminar rooms, social space and a **500-seat lecture theatre**.



Bear right and go up the slope where you will return to the main road. Cross the road then, at the mini-roundabout, follow the footpath to the right onto Darwin Road.

The building to your right is **Cornwallis East [E6]**, which opened in 2015. It is home to the School of Sociology, Social Policy and Social Research and the Graduate School.

Established in 2008, the **Graduate School** is a strategic initiative to further enhance the intellectual development and student experience of all postgraduates who study and research at the University. The School provides a strong and supportive infrastructure for postgraduate students by providing facilities and training and encouraging intellectual interaction and social networking opportunities across all the disciplines.

Postgraduate students make a vital contribution to life at Kent and play an important role in shaping the development of the postgraduate community, which is rich in culture and diversity and extends across our academic schools, faculties, campuses and four European centres.

The Graduate School works closely with the **Kent Graduate Student Association (KGSA)** and postgraduate student representatives on initiatives, and many of our activities are student-driven and co-ordinated with the support of the Graduate School Team.

The KGSA provides co-curricular opportunities through events, activities, sports and volunteering opportunities, as well as addressing the views and needs of postgraduate students by working closely with the Graduate School, Kent Union and Woolf College Master.

Continue forward and cross the road.

Darwin Houses [E4] are situated to your left.

- **Self-catered terraced houses for postgraduate students** undertaking short stay academic programmes of nine months or less, located adjacent to Woolf College and Darwin College
- Four to seven students share a house
- Students share the kitchen, shower and toilet facilities.

Continue forward and walk past the bus stop.

Cross the road and take the next turning on your right. The building in front of you is **The Registry**, bringing you to the end of your tour.

We hope that you have enjoyed your visit to the University of Kent. If you have any further questions, please contact us.

FINDING YOUR WAY AROUND THE CAMPUS





- J15 Eliot College Extension
- J16 Jarman Building
- J17 Wigoder Building
- K1 Registry
- Visitor Reception**
- Central Student Administration Office
- K3 Rutherford College Extension
- K4 Rutherford College
- K5 Tyler Court
- K6 Rutherford Annexe
- L1 Hothe Court Farmhouse
- L2 Grimshill Court
- L3 Denstead Court
- L4 Homestall Court
- M1 Clowes Court
- M2 Willows Court
- M3 Tudor Court
- N1 Medical Centre
- N2 Pharmacy
- N3 Woodlands

- N4 Rothford
- N5 Olive Cottages
- N6 Keynes College
- N7 Turing College
- P2 The Venue/ Student Media Centre
- P3 Mandela Building
- P4 Becket Court
- P5 Eliot College
- P6 Careers and Employability Service
- Q2 Beverley Farmhouse
- Other organisations based on campus**
- Blackwells Bookshop/ Caffé Nero
- Canterbury Enterprise Hub
- Open Colleges Network Kent and Medway
- Canterbury Innovation Centre
- Jobshop

- J14
- H6
- N6
- Q3
- J14

Start point

♦♦♦ Walking route

- Colleges
- Other buildings
- P Visitor Pay and Display parking
- T Taxi Rank
- Permit-holder parking only
- Main road
- Minor road
- Footpath
- Footpath unsuitable for wheelchair users
- Cycle path
- National cycle route 1
- Cycle lock up
- Cycle lock up, sheltered with secure access

OPEN DAYS AT KENT

Please visit www.kent.ac.uk/opendays
for dates and how to book.

This brochure was produced in November 2017. The University of Kent makes every effort to ensure that the information contained in its publicity materials is fair and accurate and to provide educational services as described. However, the courses, services and other matters may be subject to change. For the most up-to-date information, see: www.kent.ac.uk/ug Full details of our terms and conditions can be found at: www.kent.ac.uk/termsandconditions

University of Kent, The Registry, Canterbury, Kent CT2 7NZ
T: +44 (0)1227 764000 www.kent.ac.uk

University of
Kent